

3-Phase Basic PDU 208V

InfraPower 3-Phase Basic PDU is designed for cost efficient and reliable power distribution in data center. Customer can meet end to end equipment and management requirements using InfraPower whilst meeting budget and high power rating application demands .

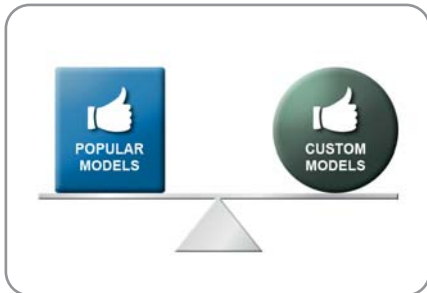

>>> Wide Range / Custom Configuration



In addition to supplying cost-effective standard PDU models with a great delivery schedule, competitive custom PDU configurations for specific user requirements are also available on short lead-times.

>>> Lockable IEC Outlet PDU



Lockable IEC Outlet PDU is available to secure plugs and prevent accidental disconnection. It is compatible to generic IEC cords and hence cost saving in locking cables.

>>> Colored PDU Chassis



Colored PDU casings provide a simple way for visualisation of power sources. Colors include black / white / red / blue.

>>> Variety of Electrical Configurations



Three Phase 20A / 30A 208V PDU solution is provided for North America market. Various configurations are available on request.

>>> Hydraulic Magnetic Circuit Breaker



MCB is essential for safety operation. Our MCB is a kind of hydraulic magnetic circuit breaker which is bundled by the InfraPower 3-Phase PDU models.

>>> PDU Mounting Options

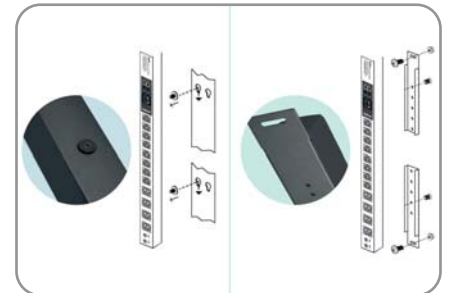

InfraPower PDUs are supplied with 2 types of mounting kits; Vertical Button Mounting Kit & Vertical Bracket Mounting Kit. The tool-less kits can be used on the majority of global branded racks.

20A / 30A

1 inch = 25.4 mm

		Length
C13	C19	inch
48		69.9 *
42		69.9 *
36		70.9
30		70.9
24		56.1
18		56.1
12		47.2
	24	65.0
	18	56.1
	12	47.2
	9	47.2
36	12	69.9 *
36	6	69.9 *
30	12	69.9 *
30	6	61.0 *
24	12	61.0 *
24	6	65.0
18	12	61.0 *
18	6	65.0
21	3	65.0
12	12	65.0
12	6	56.1

		Length
Lockable		inch
C13	C19	inch
24		65.0
18		56.1
12		47.2
	24	65.0
	18	56.1
	12	47.2
12	12	65.0
12	6	56.1

20A Inlet

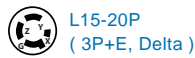

L15-20P
(3P+E, Delta)

30A Inlet

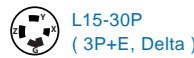

L15-30P
(3P+E, Delta)

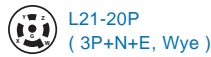

L21-20P
(3P+N+E, Wye)

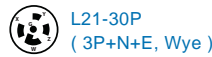

L21-30P
(3P+N+E, Wye)

* steel chassis

Order Tips

>> Outlet

C13 / C19 / C13 + C19

>> Outlet number

Please refer to the tables for standard outlet configuration. Custom configuration on request

>> Casing - Vertical

Rack U height is critical.
Please refer to the tables for your PDU dimension.

>> Circuit protection

Hydraulic Magnetic Circuit Breaker (MCB)

>> Current loading

20 Amp
30 Amp

>> Inlet / Cordset

20A - NEMA L15-20P / NEMA L21-20P
30A - NEMA L15-30P / NEMA L21-30P
Standard 2M Cordset, custom length on request

>> Power feed

Standard bottom feed
Optional top feed

>> Colors

Standard black color for **Extrusion** PDU
Standard black + white color for **Steel** PDU
Color option : blue / red / other colors on request

Basic PDU Product Code

Austin Hughes has designed a simple but informative InfraPower product code builder in order to let our clients determine the desired PDU configuration to meet their needs.

Code Structure

VP C13 - / - / / / - / /

VP C19 - / - / / / - / /

VP C13 / - / / / - / /

VP C13 - / - / / / - / /

VP C19 - / - / / / - / /

VP C13 / - / / / - / /

Digit	Indication	Examples
	- Outlet nos	IEC : C13 / C19 / C13 + C19
	- Amp	20A / 30A
	- Circuit Protection	CR = Hydraulic Magnetic Circuit Breaker (MCB)
	- Inlet	20A : NEMA L15-20P / NEMA L21-20P 30A : NEMA L15-30P / NEMA L21-30P
	- Cordset	2 = 2M / 6.56' * Custom length on request
	- Bottom feed or top feed (only for vertical PDU)	B = Bottom feed T = Top feed
	- Colored PDU casing (only for vertical PDU)	1 = Black 2 = White 3 = Red 4 = Blue
LOCK	- Lockable	IEC : C13 / C19 / C13 + C19

Product Code Example

VP36C13/6C19-30A/CR_L2130/2B-2

3-Phase Basic Vertical PDU with IEC C13 x 36 & C19 x 6 / 30A / Circuit Breaker / 2M cordset + Inlet NEMA L21-30P / Bottom Feed / White Casing

VP48C13-30A/CR_L1530/2B-2

3-Phase Basic Vertical PDU with IEC C13 x 48 / 30A / Circuit Breaker / 2M cordset + Inlet NEMA L15-30P / Bottom Feed / White Casing

VP24C19-20A/CR_L1520/2B-1

3-Phase Basic Vertical PDU with IEC C19 x 24 / 20A / Circuit Breaker / 2M cordset + Inlet NEMA L15-20P / Bottom Feed / Black Casing

VP12C13/6C19-20A/CR_L2120/2B-4/LOCK

3-Phase Basic Vertical PDU with IEC C13 x 12 & C19 x 6 / 20A / Lockable / Circuit Breaker / 2M cordset + Inlet NEMA L21-20P / Bottom Feed / Blue Casing

For more information, please visit www.austin-hughes.com

Value-Add Options :

> Colored Power Cords

C13-C14 : Red / Blue / Light Grey / Orange
2M or 3M

C19-C20 : Red / Blue
2M

> IEC Secure Sleeves

- Secure the power cord connections to the PDU IEC outlets
- Simple and cost efficient
- Sleeve attached to C14 power cord inlet : **IPP-SS-C13** (pack of 200)
- Sleeve attached to C20 power cord inlet : **IPP-SS-C19** (pack of 100)

> Warranty Upgrade from 2 Years to 5 Years

